



Custom Machine & Tool Co., Inc.
 22 Station Street
 E, Weymouth, MA 02189
 Email: info@cmtco.com
 WWW.CMTCO.COM
 Tel: 800-355-5949 Or 781-331-7770

3MM GT® Synchronous Sprockets

| 9mm (.354 in) Wide Belts (3MR-09) - .530 Face Width | | | | | | |
|---|----------------|-------|--------------------|------------------|-------------|------------------|
| Part Number | No. of Grooves | Style | Nominal Dimensions | | | |
| | | | Pitch Diameter | Outside Diameter | Flange O.D. | Length thru Bore |
| CMT19S-3MR-09-0606 | 19 | 3F | 0.714 | 0.684 | 0.827 | 0.53 |
| CMT20S-3MR-09-0609 | 20 | 3F | 0.752 | 0.722 | 0.895 | 0.53 |
| CMT21S-3MR-09-0609 | 21 | 3F | 0.79 | 0.76 | 0.895 | 0.53 |
| CMT22S-3MR-09-0609 | 22 | 3F | 0.827 | 0.797 | 0.945 | 0.53 |
| CMT24S-3MR-09-0909 | 24 | 3F | 0.902 | 0.872 | 1.025 | 0.53 |
| CMT26S-3MR-09-0912 | 26 | 3F | 0.977 | 0.947 | 1.105 | 0.53 |
| CMT28S-3MR-09-0912 | 28 | 3F | 1.053 | 1.023 | 1.173 | 0.53 |
| CMT30S-3MR-09-0912 | 30 | 3F | 1.128 | 1.098 | 1.250 | 0.53 |
| CMT32S-3MR-09-0912 | 32 | 3F | 1.203 | 1.173 | 1.323 | 0.53 |
| CMT34S-3MR-09-0912 | 34 | 3F | 1.278 | 1.248 | 1.398 | 0.53 |
| CMT36S-3MR-09-0912 | 36 | 3F | 1.353 | 1.323 | 1.478 | 0.53 |
| CMT38S-3MR-09-0912 | 38 | 3F | 1.429 | 1.399 | 1.549 | 0.53 |
| CMT38S-3MR-09-1616 | 38 | 6F | 1.429 | 1.399 | 1.549 | 0.655 |
| CMT40S-3MR-09-0912 | 40 | 3F | 1.504 | 1.474 | 1.625 | 0.53 |
| CMT40S-3MR-09-1616 | 40 | 6F | 1.504 | 1.474 | 1.625 | 0.655 |
| CMT45S-3MR-09-1212 | 45 | 3F | 1.692 | 1.662 | 1.775 | 0.53 |
| CMT45S-3MR-09-1616 | 45 | 6F | 1.692 | 1.662 | 1.775 | 0.655 |
| CMT50S-3MR-09-1212 | 50 | 3 | 1.88 | 1.85 | - | 0.53 |
| CMT50S-3MR-09-1616 | 50 | 6 | 1.880 | 1.85 | - | 0.655 |
| CMT56S-3MR-09-1212 | 56 | 3 | 2.105 | 2.075 | - | 0.53 |
| CMT56S-3MR-09-1616 | 56 | 6 | 2.105 | 2.075 | - | 0.655 |
| CMT62S-3MR-09-1212 | 62 | 3 | 2.331 | 2.301 | - | 0.53 |
| CMT62S-3MR-09-1616 | 62 | 6 | 2.331 | 2.301 | - | 0.655 |
| CMT68S-3MR-09-1212 | 68 | 3 | 2.557 | 2.537 | - | 0.53 |
| CMT68S-3MR-09-1616 | 68 | 6 | 2.557 | 2.537 | - | 0.655 |
| CMT74S-3MR-09-1212 | 74 | 3 | 2.782 | 2.752 | - | 0.52 |
| CMT74S-3MR-09-1616 | 74 | 6 | 2.782 | 2.752 | - | 0.655 |
| CMT80S-3MR-09-1212 | 80 | 3 | 3.008 | 2.978 | - | 0.53 |
| CMT80S-3MR-09-1616 | 80 | 6 | 3.008 | 2.978 | - | 0.655 |

Patent Number 6,568,063 Custom Machine & Tool Co., Inc

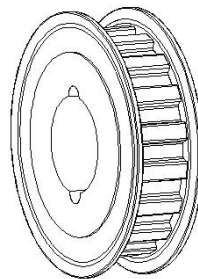
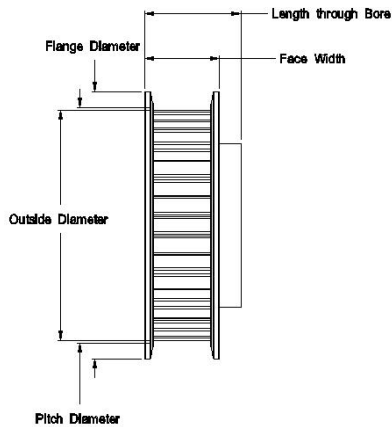

STYLE CODES:

- 3F** Flanges both sides no hub
- 3** No flanges no hub
- 6F** Flanges both sides with hub
- 6** No flanges with hub

CMT® is a registered trademark of Custom Machine & Tool Co., Inc.
 Copyright © 1998-2004 Custom Machine & Tool Co., Inc. All rights reserved.
 GT® is a registered trademark of Gates Corporation